

OMRON

PHARMA
INSPECTION
SYSTEM





SKS - plug control system

BRIEF DESCRIPTION

Plug control system **SKS** for plug gap and plug type control on vials, prior to the application of the crimp caps according to GMP Annex1 (121).

The customised cameras are integrated in an isolator-compatible **stainless steel** (AISI 316L) / PVDF housing, which was developed according to hygiene and **laminar flow** (LF) aspects.

Due to the compact arrangement, the system can be ideally integrated into the filling line, even of existing plants

The SKS system can be optimally used in linear lines as well as in rotary machines.

The plug gap inspection is carried out with **2 cameras**, arranged at an angle of 90° and a specially developed LED backlight with integrated controller.

A third camera with integrated lightning can be installed for plug type control.

The system is suitable for the inspection of vials with a plug diameter of **13-32 mm**.



SKS - plug control system

FEATURES

- housing made of stainless steel 1.4404 (AISI 316L) / PVDF
- hygienic, insulator-suitable, LF-optimised design
- protection against external influences such as dust, dirt, moisture and also resistant to alcohol, H₂O₂
- anti-reflective real glass protective panes (replaceable)
- developed and manufactured in accordance with GMP
- high chemical resistance of all seals
- cable feed-through in machine base
- height adjustment required on site (see connection diagram) or available as accessories
- customer-specific adaptation possible (3xM8 /TK-Ø66)
- LED status display 24VDC RGB
- LED- Backlight 24VDC red (infrared) with integrated controller

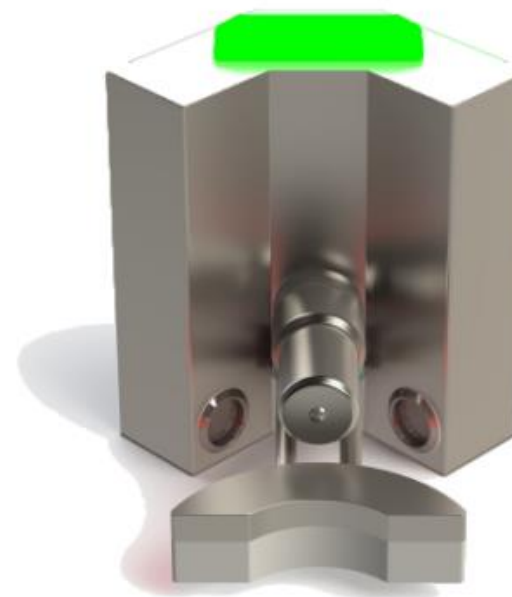

- ← LED status display RGB
- ← central body
Stainless steel 1.4404
- ← camera tunnel
Plug type control SKS-300
- ← camera window
Plug gap control
- ← LED Backlight (red or infrared)

OMRON

SKS - plug control system

TECHNICAL DATA

Ambient temperature: 0°C....40°C

Protection class: IP69K

camera dimensions for plug gap
inspection max. 40 x 40 x H
100mm

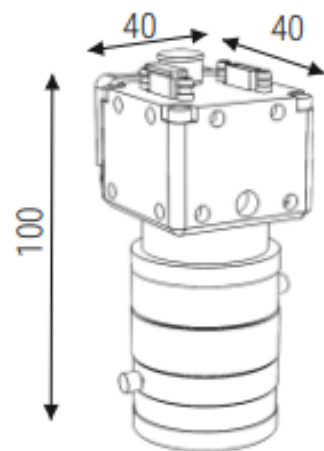

camera dimensions
for plug type control
max. 45 x 45 x H 100mm

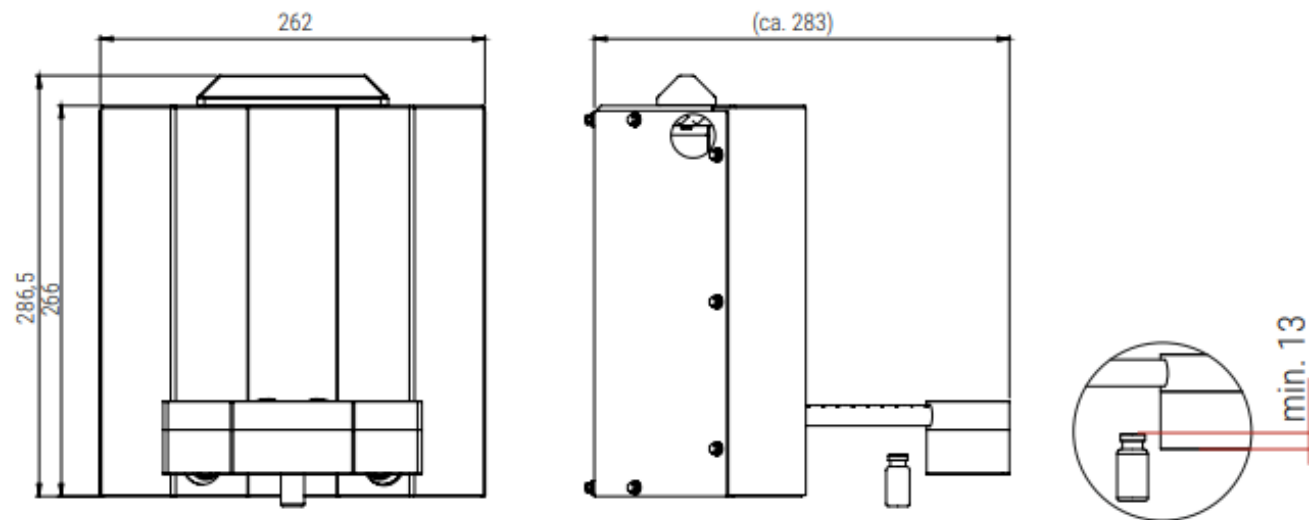
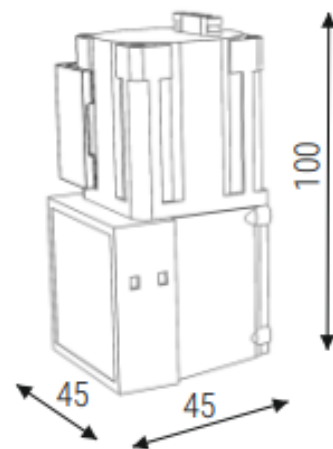

pos. test level - lower edge of Backlight

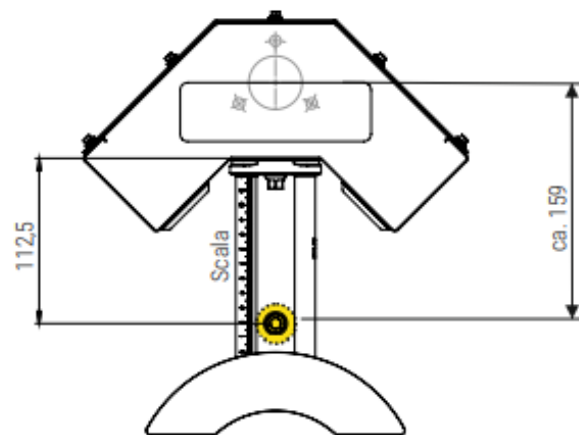

flange mounting
lifting column
Dmax: 90mm

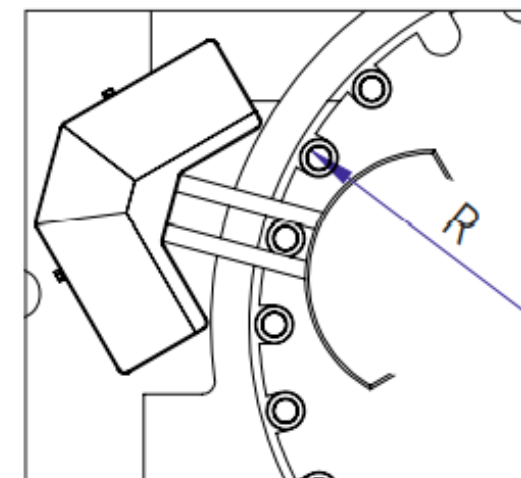
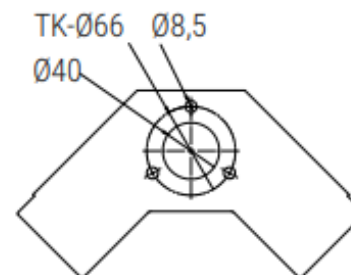

smallest star wheel diameter
240 mm



SKS - plug control system

EXAMPLE APPLICATION

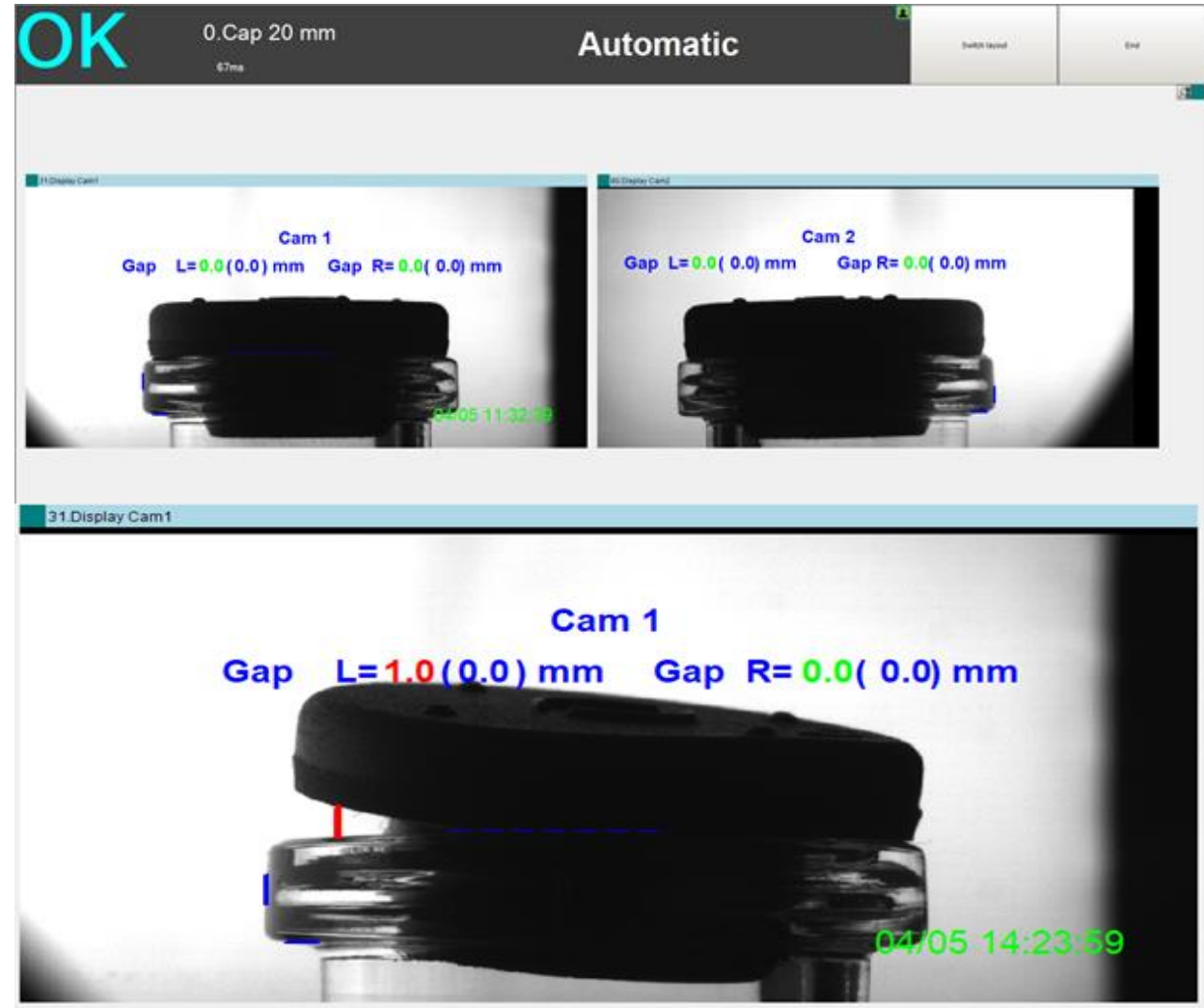



BKS - Crimp Cap Inspection 4 x 90°

BRIEF DESCRIPTION

Crimp cap inspection system **BKS-400** for visual evaluation of the flanging cap quality according to GMP Annex1 (121).

The customer-specific cameras are integrated in an isolator compatible **stainless steel** (AISI 316L) / PVDF housing, which was developed according to hygienic and **laminar flow** (LF) aspects.

Due to the compact arrangement, the system can be ideally integrated into the filling line, even in existing lines. The BKS system can be implemented both in linear lines as well as in rotary machine setups.

The flanged cap inspection is equipped with a **4 cameras** system arranged in a 90° degree angle, an adjustable mirror systems as well as a specially developed, diffuse, **reflection-free LED incident light** illumination with integrated controller.

The system is suitable for the inspection of vials with cap diameter **13-32 mm**.



BKS - Crimp Cap Inspection 4 x 90°

FEATURES

- housing made of stainless steel 1.4404 (AISI 316L) / PVDF
- hygienic, insulator-suitable, LF-optimised design
- protection against external influences such as dust, dirt, moisture and also resistant to alcohol, H₂O₂
- protective panes real glass anti-reflective (exchangeable)
- developed and manufactured in accordance with GMP
- high chemical resistance of all seals
- cable bushing in machine base
- height adjustment required on site (see connection diagram) or available as accessories
- customer-specific adaptation possible (3xM8 /TK-Ø66)
- LED status display 24VDC RGB
- LED incident light illumination 24VDC white

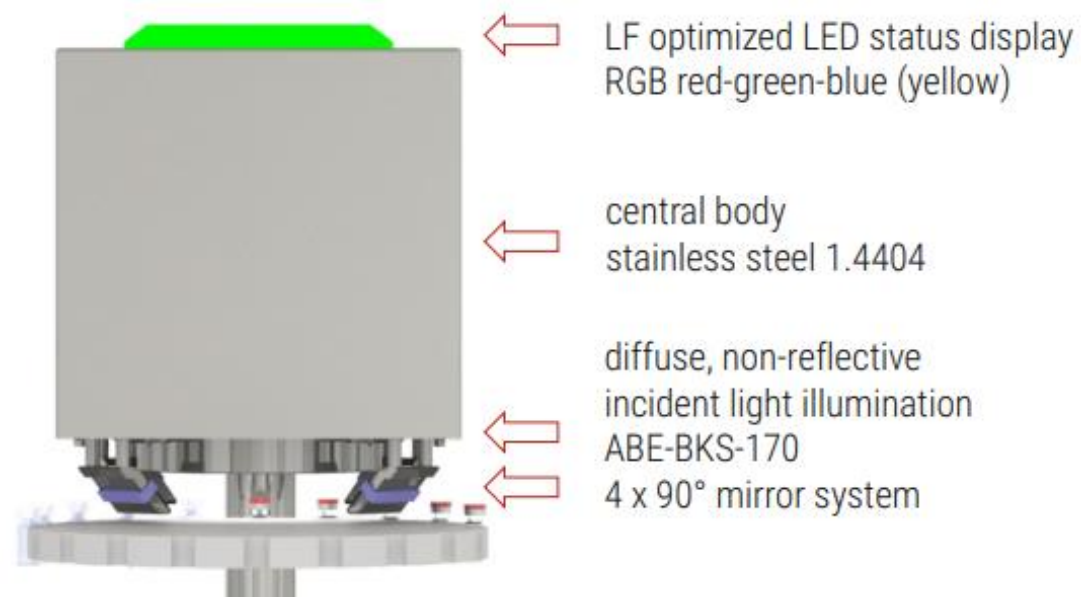



BKS - Crimp Cap Inspection 4 x

TECHNICAL DATA

Ambient temperature: 0°C....40°C

Protection class: IP69

camera dimensions for plug gap
inspection max. 40 x 40 x H
100mm

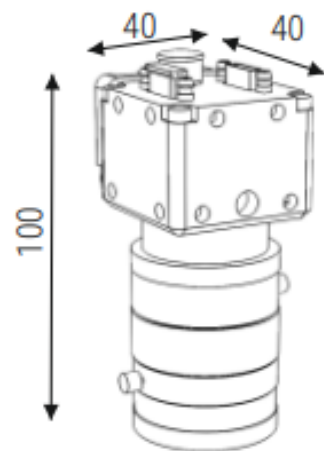

flange mounting
lifting column Dmax: 90 mm

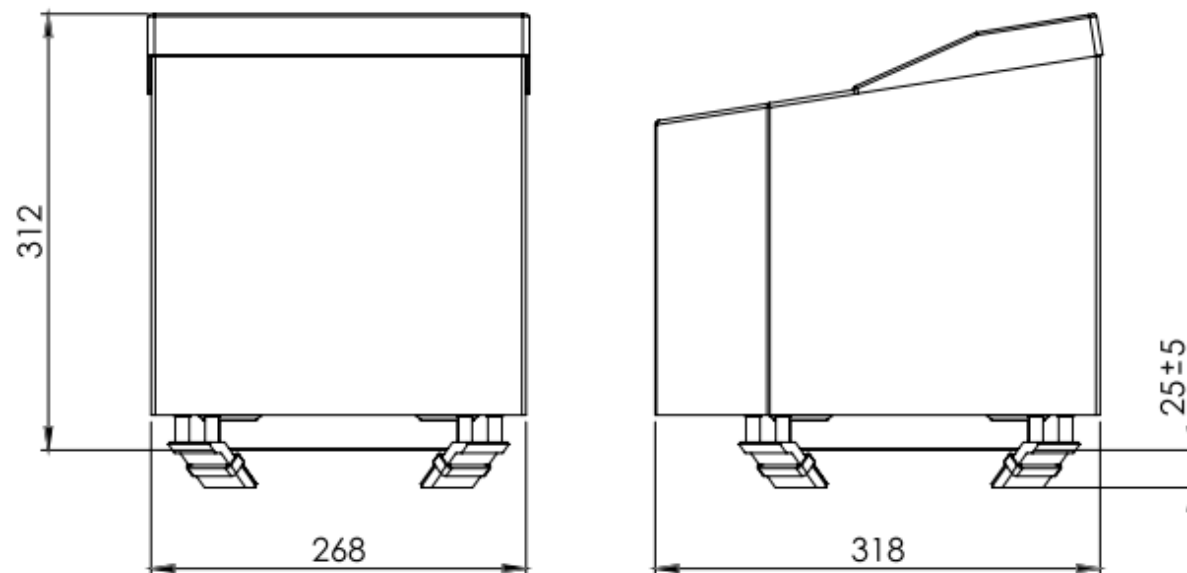
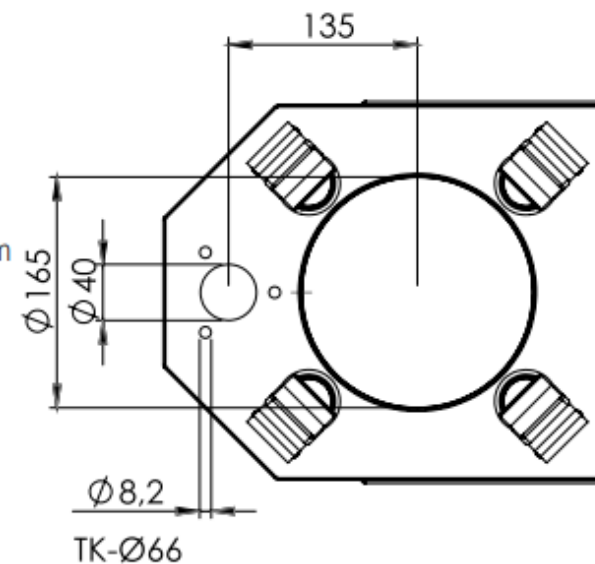

smallest star wheel - diameter
240 mm



BKS - Crimp Cap Inspection 4 x 90°

EXAMPLE APPLICATION

